

Production

Grass Valley K-Frame 3G Switcher
- Kayenne 4 Stripe 35 Button Panel
7 M/E, 90 Inputs, 48 Outputs
FlexiKey, Double Take and Chroma Key
12- IDPM, 4- EDPM and 2D DPM
Image Store w/movies

Record & Playback

(2) EVS XT3 12ch LSM Dual User Servers
(1) EVS HD LSM-XT3 8 Channel Video Servers
spotbox
Lance TDC 100 DDR Controller
(1) EVS X-file3 w/ 10G File Network
(1) EVS X-hub3

Camera Equipment

(9) Grass Valley LDX 86/80 World Cam Cameras
(1) Grass Valley LDX 86 Extreme Camera
(7) Grass Valley Super XPanders w/7" Viewfinders
(1) Fujinon 101x.9.8 HD Lens
(1) Fujinon 99x8.4 HD Lenses
(3) Fujinon 88x8.8 HD Lens
(1) Fujinon 72x9.3 HD Lens
(4) Fujinon 22x7.8 Zoom Lenses
(1) Fujinon 12x4.5 Wide Angle Lenses
(7) Vinten Vector 70 Pan Heads
(2) Vinten 250 Pan Heads/Tripods
(2) Vinten 100 Pan Heads/Tripods
(2) LPS Cameras
Wired for 16 CCU's

Audio

Calrec Alpha 100 Bluefin
-72 Faders Digital Audio Console
-128x128 Analog
-80x80 AES
-256x256 MADI
(2) Daysequerra Down Mix Encoders
(2) Daysequerra Up Mix Decoders
(2) Daysequerra Mono2Stereo
(1) Daysequerra ILM 8 Loudness Meter

Communications

168x168 CH RTS Adam Matrix Intercom Including
-64 Channels RTS Omneo
-16 Rvon Channels
-12 Powered PL Channels
-16 Powered PL Channels
(20) Dual Listen BP325 Boxes
(14) IFB 4030 Boxes
(16) Single Muff Headsets
(6) Dual Muff Headsets
(4) RTS Telephone Interfaces
(4) QKT Audio Couplers

Routing & Terminal

Evertz EQX 3G Video Router (268x236)
Evertz EMR Audio Router
-512x512 Madi
-96x96 AES
-96x192 Analog
(25) For-A U/D/C Frame Syncs w/Color
Correction
(6) TX Processors w-U/D/C
200x24 Multiview Capacity

A/V Support

(5) HMD26 Annc Headsets
(5) Studio Tech Annc Boxes
(5) MD46 Stick Mics
(4) MKH416 Shotgun Mics
(4) MKH807 Long Shotgun Mics
(4) MKH418 Stereo Shotgun Mics
(4) 15" SDI Monitors
(4) 21" SDI Monitors
(2) LED Light Kits

Cable Inventory

7000' Triax, 675' SMPTE
3 - 150' 6 Wire Triax Looms
4000' DT12 Audio Mult
1000' 6 Pair Audio Snake
500' 2 Pair Audio Snake
4 - 125' 10 Wire Coax Looms
3 - 250' TAC12, 4 - 250' TAC6

Power Requirements

Three Phase, 190-280 Volts, 200A/Leg
-200' Feeder Cable per mobile unit

Truck Dimensions

Working dimension 57' long x 22' Wide
78' Overall Length, 80,000# GVW w/Truck

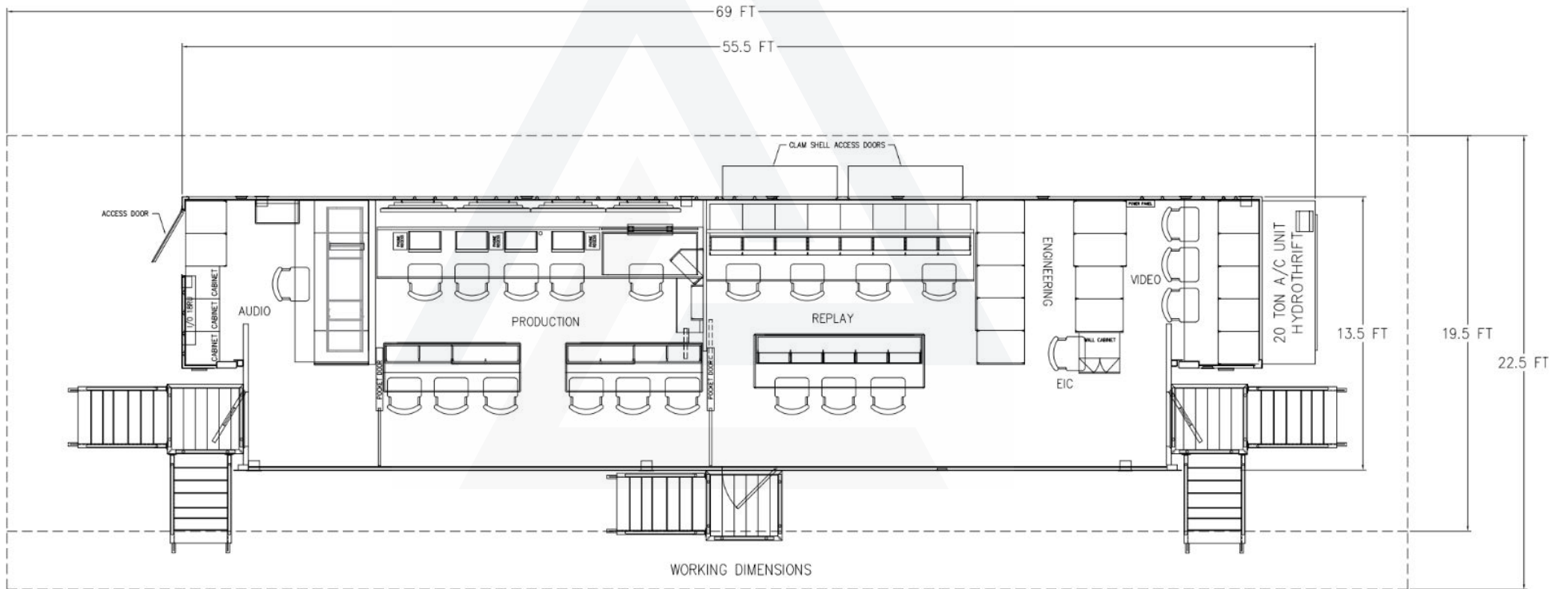

I will fill in from previous page
MONITOR WALL LAYOUT

MONITOR 1A				MONITOR 2A				MONITOR 3A				MONITOR 4A				MONITOR 9A (P2-CG)						
										12:00PM												
1	2	3	4	1	2	3	4	1	2		3	4					1		2			
				12:00PM																		
5	6	7	8	PROGRAM				5	6							2	4	6	8	9		
										PROGRAM	PREVIEW					10	11	12				
9	10	11	12	7	8	9									13	14	15	16				
MONITOR 5A				MONITOR 6A				MONITOR 7A				MONITOR 8A				MONITOR 9A (P3-BUG)						
1	2	3	4	1	2	3	4	1	2	3	4	1	2	3	4	5						
																6	7	8	9	10		
5	6	7	8	5	6	7	8	5	6	7	8	5	6	7	8	11	12	13	14	15		
9	10	11	12	9	10	11	12	9	10	11	12	9	10	11	12	16				6	7	8

Michael, the original
looks this shitty....

I will fill in from previous page
SWITCHER INPUTS & OUTPUTS

SWITCHER INPUTS

IN	Default	Show Name	Operator	Source	IN	Default	Show Name	Operator	Source	IN	Default	Show Name	Operator	Source	IN	Default	Show Name	Operator	Source
1	CAM 1				25	EVS 2A				49	FS 9				73	BLACK			
2	CAM 2				26	EVS 2B				50	FS 10				74	BLACK			
3	CAM 3				27	EVS 3A				51	FS 11				75	BARS			
4	CAM 4				28	EVS 3B				52	FS 12				76	BLACK			
5	CAM 5				29	EVS 4A				53	FS 13				77	BUG2 F			
6	CAM 6				30	EVS 4B				54	FS 14				78	BUG2 K			
7	CAM 7				31	EVS 5A				55	FS 15				79	BLACK			
8	CAM 8				32	EVS 5B				56	FS 16				80	BLACK			
9	CAM 9				33	EVS 5C				57	CG 1A F				81	BLACK			
10	CAM 10				34	EVS 5D				58	CG 1A K				82	CG 1A F			
11	CAM 11				35	EVS 6A				59	CG 1B F				83	CG 1A K			
12	CAM 12				36	EVS 6B				60	CG 1B K				84	CG 1B F			
13	CAM 13				37	EVS 7A				61	CG 2A F				85	CG 1B K			
14	CAM 14				38	EVS 7B				62	CG 2A K				86	CG 2A F			
15	CAM 15				39	EVS 8A				63	CG 2B F				87	CG 2A K			
16	CAM 16				40	EVS 8B				64	CG 2B K				88	CG 2B F			
17	CAM 17				41	FS 1				65	TELE F				89	CG 2B K			
18	CAM 18				42	FS 2				66	TELE K				90	BUG F			
19	CAM 19				43	FS 3				67	BUG F				91	BUG K			
20	CAM 20				44	FS 4				68	BUG K				92	TELE F			
21	CAM 21				45	FS 5				69					93	TELE K			
22	CAM 22				46	FS 6				70					94	RTR FEED			
23	CAM 23				47	FS 7				71					95	BLACK			
24	CAM 24				48	FS 8				72					96	BARS	BARS		

SWITCHER OUTPUTS

OUT		OUT	
1	AUX 1	25	ME 2 A
2	AUX2	26	ME 2 Pa
3	AUX 3	27	ME 2 C
4	AUX 4	28	ME 2 D
5	AUX 5	29	ME 3 A
6	AUX 6	30	ME 3 Pa
7	AUX 7	31	ME 3 c
8	AUX 8	32	ME 3 D
9	IS-1	33	PRESET
10	IS-2	34	S2 PRESET
11	IS-3	35	S2 ME 1 CLN
12	IS-4	36	S2 ME 2 CLN
13	IS-5	37	Pg A
14	S2 IS-6	38	PgPA
15	S2 IS-7	39	Pg B
16	S2 IS-8	40	CLEAN
17	S2 IS-9	41	Pg D
18	S2 IS-10	42	S2 Pg A
19	EDPM A	43	S2 PgPA
20	EDPM C	44	S2 Pg C
21	ME 1 A	45	S2 ME 1A
22	ME 1pA	46	S2 ME1 Pa
23	ME 1 C	47	S2 ME 2 A
24	ME 1D	48	S2 ME 2 Pa

>SWITCHER OUT 33 IS CLEAN